

Ship Rock

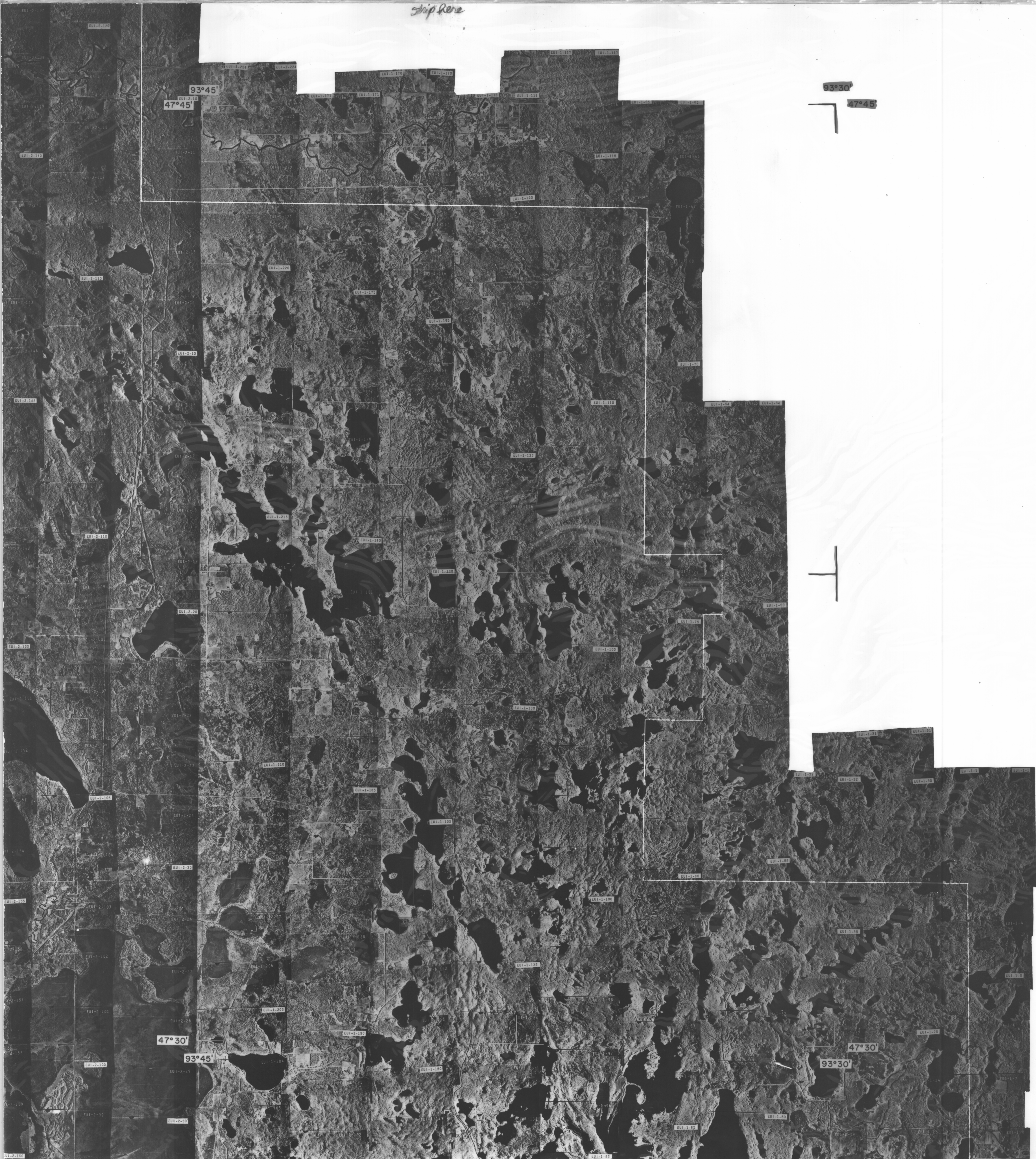

93°45'  
47°45'

93°30'  
47°45'

47°30'

47°30'

93°45'

93°30'

U. S. DEPARTMENT OF AGRICULTURE  
FOREST SERVICE

INVITATION NO 1-69-516

*1969*

PARK AERIAL SURVEYS, INC., LOUISVILLE, KENTUCKY  
COMPLETED 1969 VERTICAL AERIAL NEGATIVE SCALE 1:15,840  
INFRA-RED FILM, SYMBOL EUI F.L. 8.25 IN.  
REPRODUCTIONS AVAILABLE FROM CHIEF, U.S. FOREST SERVICE, WASHINGTON, D.C. 20250

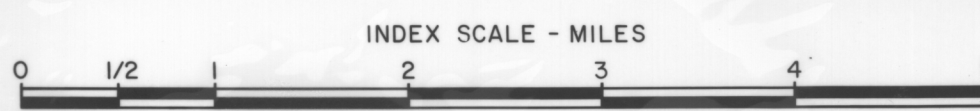

CHIPPEWA NATIONAL FOREST  
NO PHOTOS MINNESOTA  
IN LIBRARY SHEET 7 OF 16

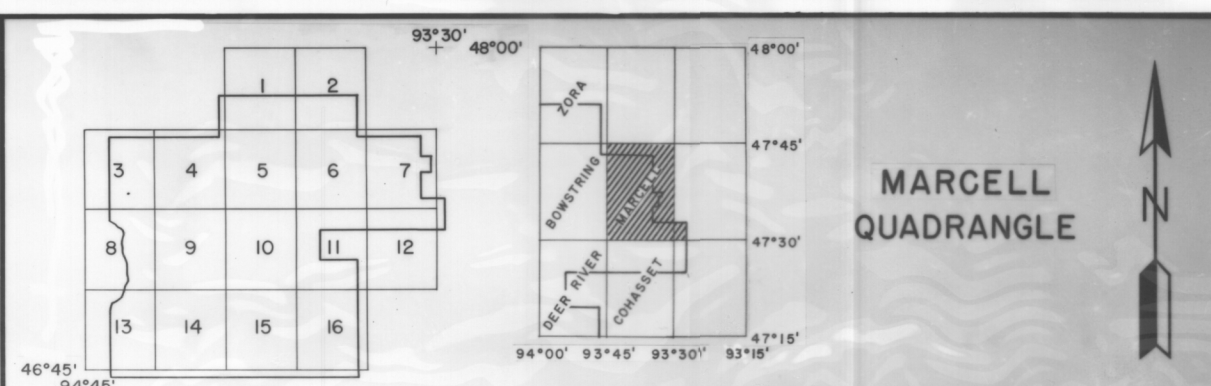

MARCELL  
QUADRANGLE