

HUB 4 210

HUB 3 100

STAMBOAT LAKE

HUB 4 240

HUB 3 70

HUB 2 191  
HUB 3 105

HUB 2 196

GARFIELD LAKE

HUB 3 103

HUB 3 208

HUB 3 190

LAPORTE

HUB 4-1

MINN 200

HUB 4 180

US-71 & MINN 200

LAKE GEORGE

HUB 4 90

HUB 2 70

HUB 4 100

HUB 2 90

HUB 4 200

KAREKOMA LAKE

HUB 2 190

BENEDICT LAKE

LEECH LAKE

HUB 4 250

HUB 3 200

HUB 2 150

HUB 3 60

HUB 3 150

HUB 4 150

MARTRAP LAKE

HUB 4 50

HUB 2 80

HUB 6 129

HUB 4 90

UPPER BOTTLE LAKE

HUB 2 20

HUB 4 190

BIG SAND LAKE

HUB 3 190

CROOKED LAKE

HUB 2 120

ELEVENTH  
CROW WING LAKE

STRIP 16 HUB 6 16

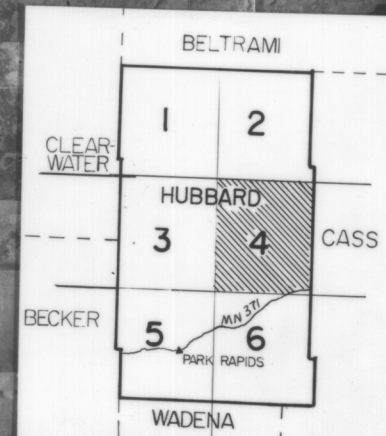

**Film Negative**  
 HUBBARD COUNTY, MINNESOTA

PHOTOGRAPHY SCALE-1:15,840  
 FLIGHT HEIGHT-7920'  
 CAMERA-21125  
 FOCAL LENGTH-152.348 m.m.  
 FILM TYPE-2424  
 FLYING COMPLETED-9-23-78

*Mark Hurd*  
 AERIAL SURVEYS, INC.  
 MINNEAPOLIS, MINNESOTA  
 SANTA BARBARA, CALIF. SAN JUAN, PUERTO RICO

APPROXIMATE SCALE IN FEET  
 1"=5280'

SHEET 4 OF 6



LITTLE SAND LAKE

HUB 3 160

NEVIS

EIGHTH  
CROW WING LAKE

HUB 4 160

BELLE TAINE LAKE

HUB 2 90