

U. S. G. S.
FILE COPY
Inspection and Editing.

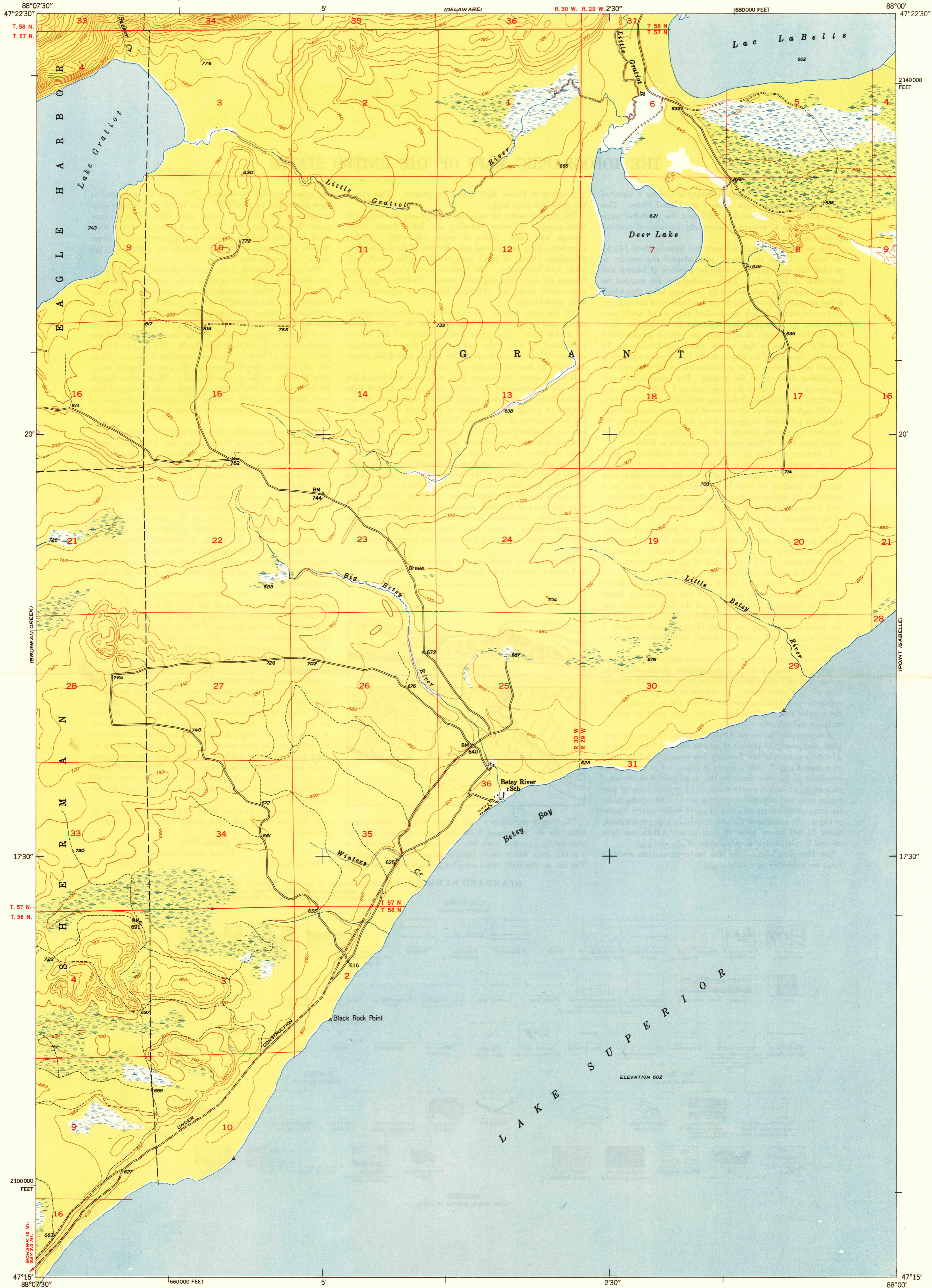

U. S. G. S.
FILE COPY
Inspection and Editing.

U. S. G. S.
FILE COPY
Inspection and Editing.

Mapped, edited, and published by the Geological Survey
Control by USGS and USC & GS
Topography from aerial photographs by multiplex methods
Aerial photographs taken 1943 Field check 1948
Polyconic projection. 1927 North American datum
10,000-foot grid based on Michigan coordinate system
west zone

TRUE NORTH
MAGNETIC NORTH
APPROXIMATE MEAN
DECLINATION, 1948

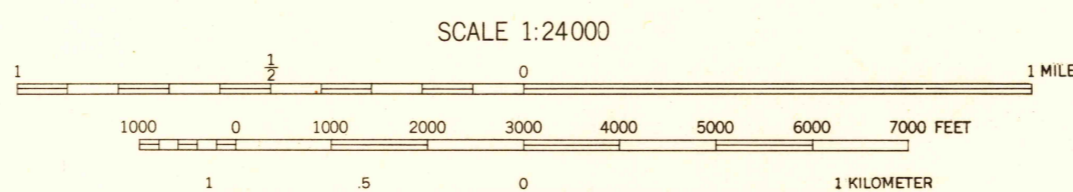

CONTOUR INTERVAL 20 FEET
DATUM IS MEAN SEA LEVEL

USGS
Historical File
Topographic Division

ROAD CLASSIFICATION
HARD-SURFACE ALL WEATHER ROADS DRY WEATHER ROADS
Heavy-duty. — 4 LANE IS LANE Improved dirt. — — —
Medium-duty. — 4 LANE IS LANE Unimproved dirt. — — —
Loose-surface, graded, or narrow hard-surface. - - - -
U. S. Route U. S. Route State Route

DEER LAKE, MICH.
N4715—W8800/7.5

PRINTED 1949

THIS MAP COMPLIES WITH NATIONAL MAP ACCURACY STANDARDS
FOR SALE BY U. S. GEOLOGICAL SURVEY, WASHINGTON 25, D. C.

U. S. G. S.
FILE COPY
Inspection and Editing.

JUN 21 1949 2080