

U. S. G. S.  
FILE COPY  
Inspection and Editing.

U. S. G. S.  
FILE COPY  
Inspection and Editing.

C.H. Birdseye, Chief Topographic Engineer.  
W.H. Herron, Division Topographic Engineer.  
Topography by J.H. Jennings, R.F. Wilcoxon,  
E.G. Wingate, and E.C. Burt.  
Control by U.S. Coast and Geodetic Survey, J.R. Ellis,  
H.S. Senseney, R.B. Steele, and E.C. Bibbee.  
Surveyed in 1920-1921.

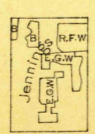

Scale 1:62,500  
0 1 2 3 4 5 Miles  
0 1 2 3 4 5 Kilometers  
Contour interval 10 feet.  
Datum is mean sea level.

USGS  
Historical File  
Topographic Division

Polyconic projection, North American datum.  
5000 yard grid based upon U.S. zone system, B.  
THROUGH ROUTES  
SECONDARY ROUTES  
SECTIONS IN POOR CONDITION  
OCT 11 1923  
MARSHALL, MICH.  
Edition of 1923.

3465