

U. S. G. S.  
**FILE COPY**  
Inspection and Editing.

U. S. G. S.  
**FILE COPY**  
Inspection and Editing.

Glenn S. Smith, Division Engineer  
Compiled in part from aerial photographs  
taken by Air Corps. U. S. Army  
Control by U. S. Geological Survey and U.S. Lake Survey  
Surveyed in 1931

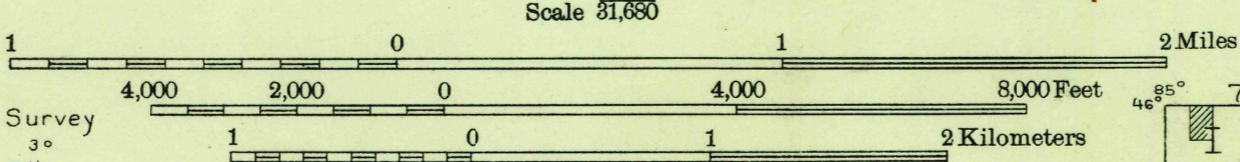

TRUE NORTH  
MAGNETIC NORTH  
APPROXIMATE MEAN  
DECLINATION, 1931

USGS  
Historical File  
Topographic Division

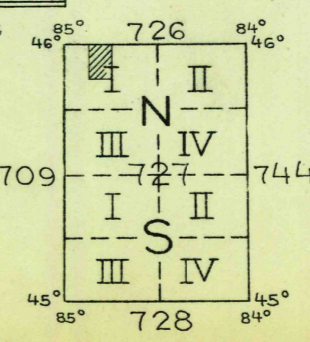

U. S. G. S.  
**FILE COPY**  
Inspection and Editing.

MORAN, MICH.  
N.E.  
N4552.5-W8445.7/5