

UNITED STATES
DEPARTMENT OF THE INTERIOR
GEOLOGICAL SURVEY

STATE OF MICHIGAN
REPRESENTED BY THE
DEPARTMENT OF CONSERVATION
GEOLOGICAL SURVEY DIVISION
(Ozark SW)

MICHIGAN
(MACKINAC COUNTY)
MORAN QUADRANGLE
NW QUARTER

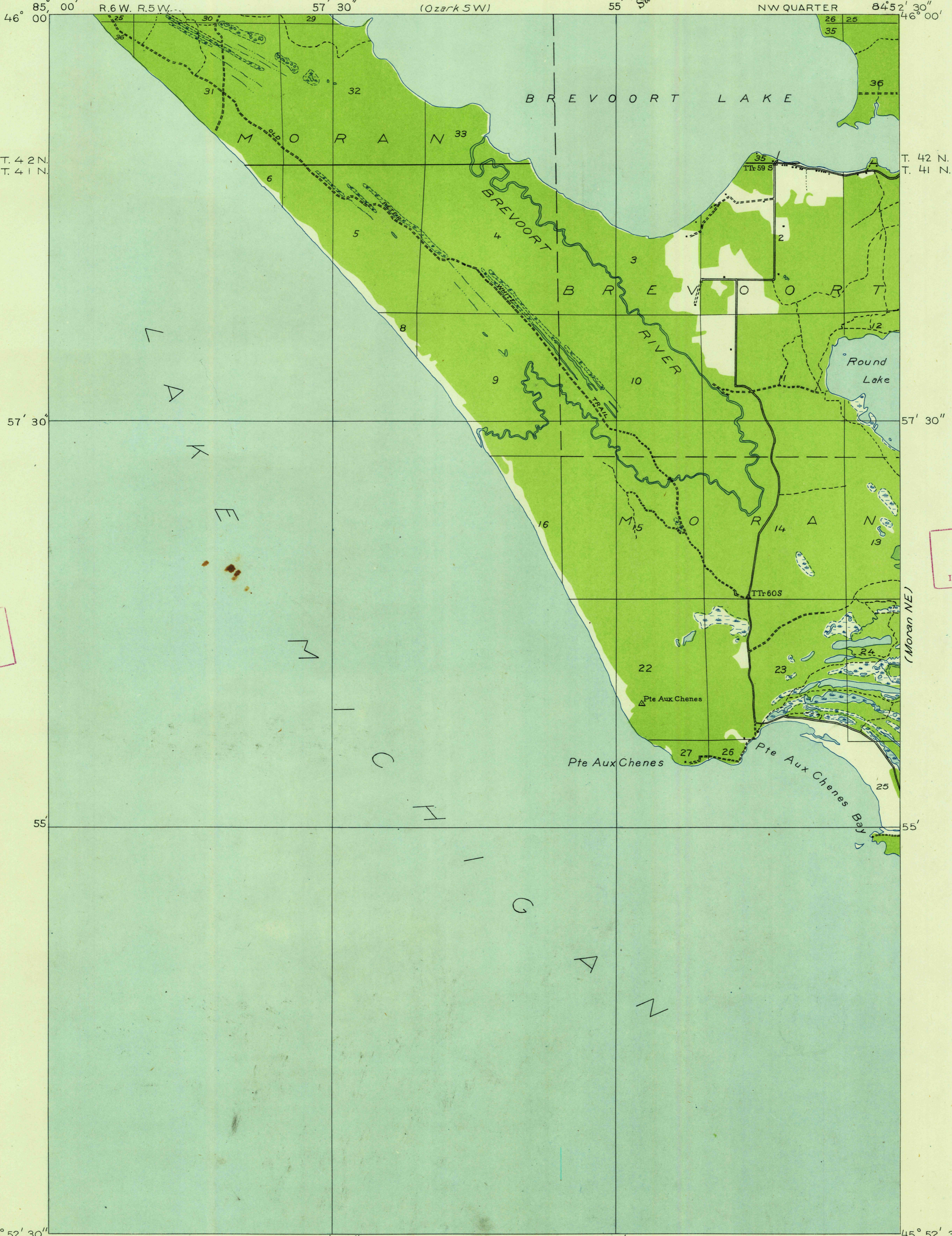

U. S. G. S.
FILE COPY
Inspection and Editing.

U. S. G. S.
FILE COPY
Inspection and Editing.

Glenn S. Smith, Division Engineer
Compiled in part from aerial photographs
taken by Air Corps, U. S. Army
Control by U. S. Geological Survey and U. S. Lake Survey
Surveyed in 1931

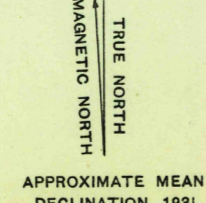
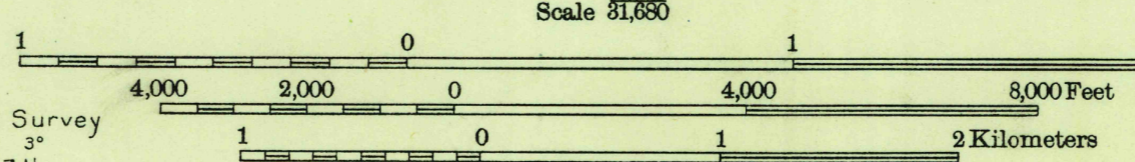

USGS
Historical File
Topographic Division

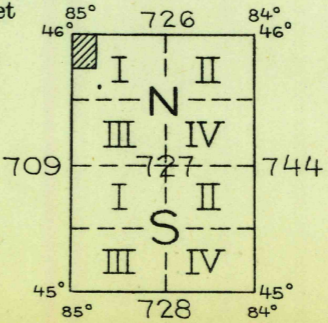

U. S. G. S.
FILE COPY
Inspection and Editing.

MORAN, MICH.
NW
N4552.5-W8452.5/75

JUN 23 1948

1075