

Advance sheet
Subject to correction

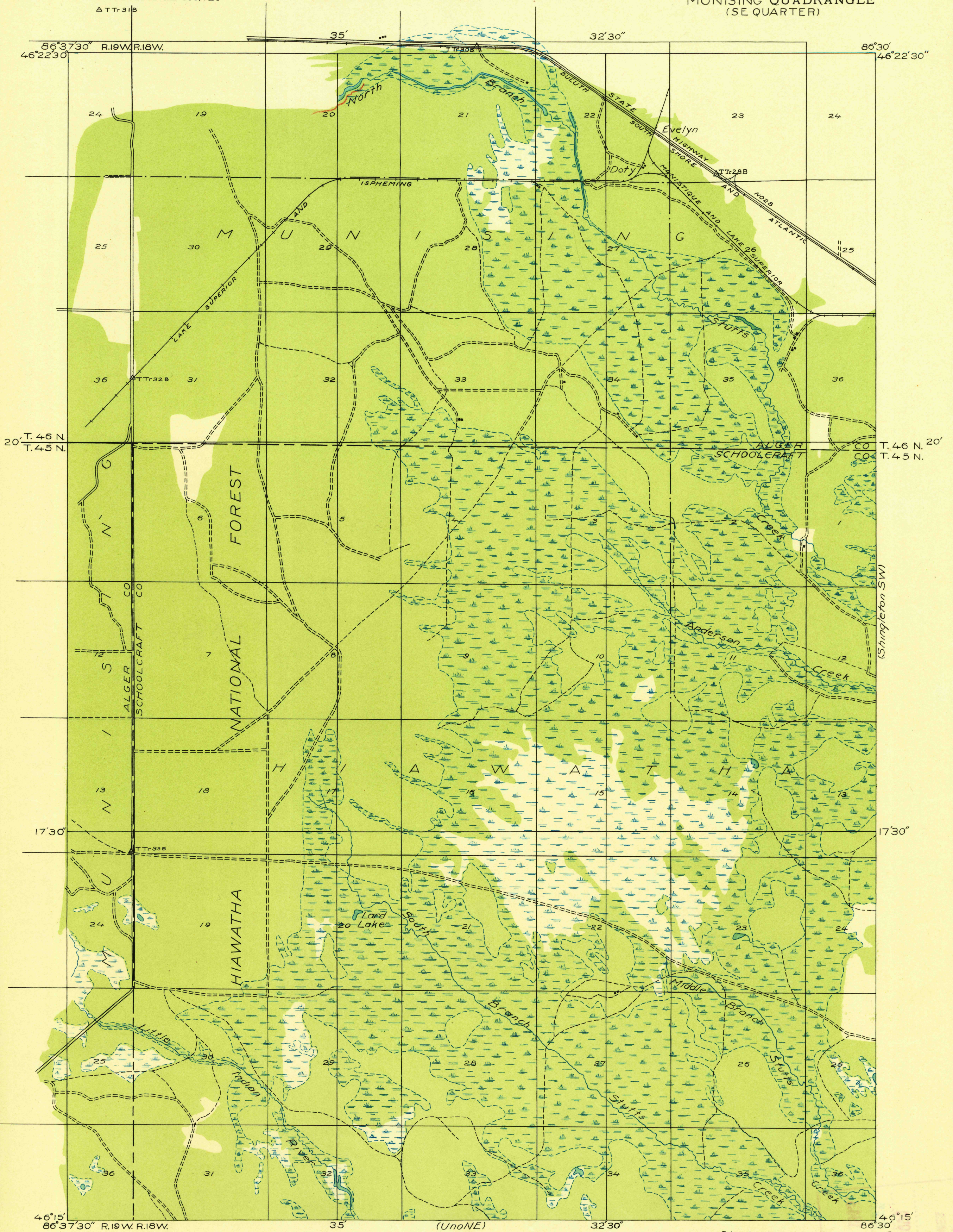

Glenn S. Smith, Division Engineer
Compiled in part from aerial photographs
taken by Air Corps, U. S. Army
Control by U. S. Geological Survey
Surveyed in 1931

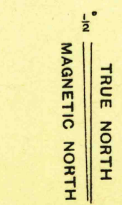

APPROXIMATE MEAN
DECLINATION, 1931

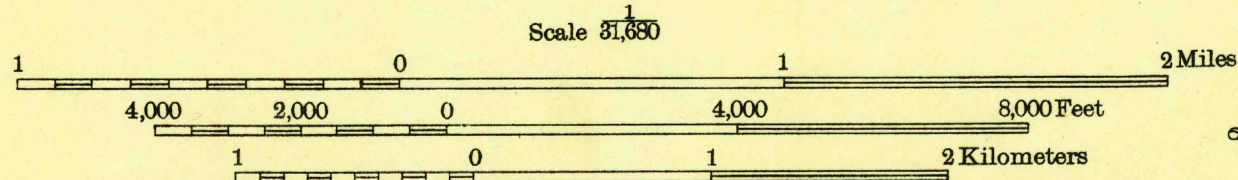

Polyconic projection. North American datum

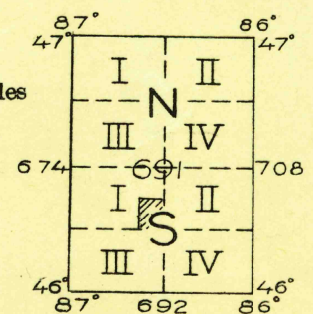

U. S. Board on
Geographical Names

MUNISING, MICH.
(SE)