

UNITED STATES
DEPARTMENT OF THE INTERIOR
GEOLOGICAL SURVEY

WINTHROP SW QUADRANGLE
MINNESOTA-SIBLEY CO.
7.5 MINUTE SERIES (TOPOGRAPHIC)
SW/4 WINTHROP 15' QUADRANGLE
HUTCHINSON 18 MI.
7 MI. TO U.S. 212

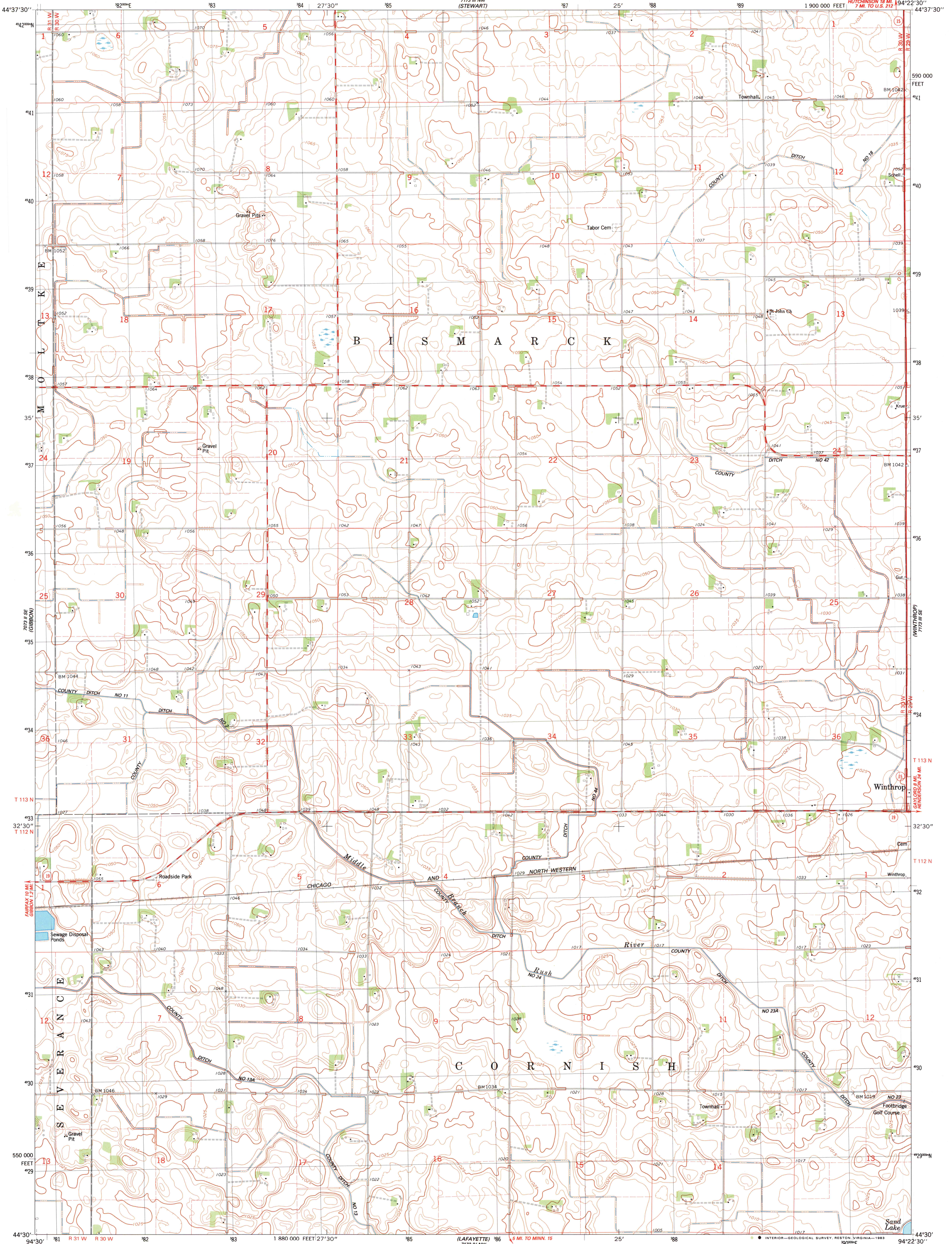

Mapped, edited, and published by the Geological Survey

Control by USGS and NOS/NOAA

Topography by photogrammetric methods from aerial photographs
taken 1975. Field checked 1977. Map edited 1982

Projection and 10,000-foot grid ticks: Minnesota coordinate
system, south zone (Lambert conformal conic)
1000-meter Universal Transverse Mercator grid, zone 15
1927 North American Datum

To place on the predicted North American Datum 1983
move the projection lines 6 meters north and
20 meters east as shown by dashed corner ticks

Fine red dashed lines indicate selected fence and field lines where
generally visible on aerial photographs. This information is unchecked

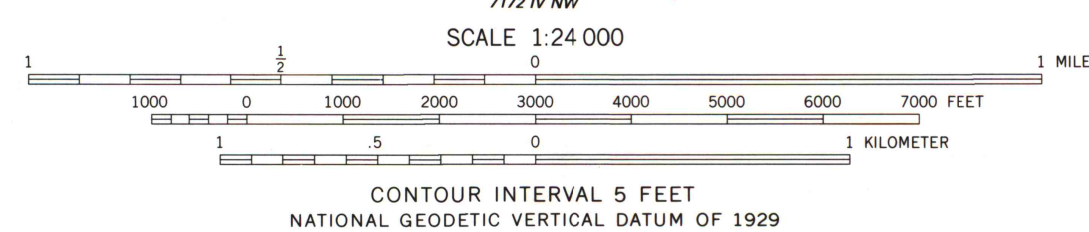
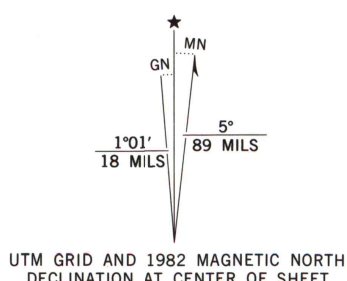

ROAD CLASSIFICATION	
Primary highway, hard surface	Light-duty road, hard or improved surface
Secondary highway, hard surface	Unimproved road
Interstate Route	U. S. Route
	State Route

WINTHROP SW, MINN.
SW/4 WINTHROP 15' QUADRANGLE
N4430-W9422.5/7.5

1982

DMA 7173 III SW-SERIES 7872

A.H. ROBINSON
MAP LIBRARY

MAY 2 8 1984

University of Wisconsin
Madison