

Mapped, edited, and published by the Geological Survey
 Control by USGS and USC&GS
 Topography by photogrammetric methods from aerial photographs taken 1966. Field checked 1967
 Depth curves and soundings compiled from charts furnished by Minnesota Department of Conservation
 Polyconic projection. 1927 North American datum 10,000-foot grid based on Minnesota coordinate system, south zone 1000-meter Universal Transverse Mercator grid ticks, zone 15, shown in blue
 Fine red dashed lines indicate selected fence and field lines where generally visible on aerial photographs. This information is unchecked

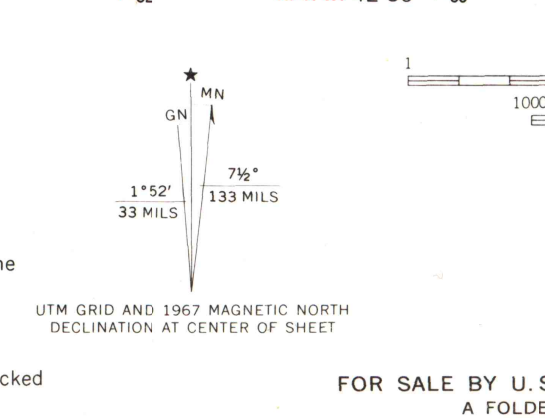

THIS MAP COMPLIES WITH NATIONAL MAP ACCURACY STANDARDS
 FOR SALE BY U. S. GEOLOGICAL SURVEY, DENVER, COLORADO 80225, OR WASHINGTON, D. C. 20242
 A FOLDER DESCRIBING TOPOGRAPHIC MAPS AND SYMBOLS IS AVAILABLE ON REQUEST

ROAD CLASSIFICATION
 Heavy-duty ——— Light-duty ———
 Medium-duty ——— Unimproved dirt ———
 U. S. Route ——— State Route ———

MAP AND AIR PHOTO LIBR.
 SEP 22 1969
 University of Wisconsin

CURRIE, MINN.
 N4400—W9537.5/7.5
 1967
 AMS 6872 II SW—SERIES V872