

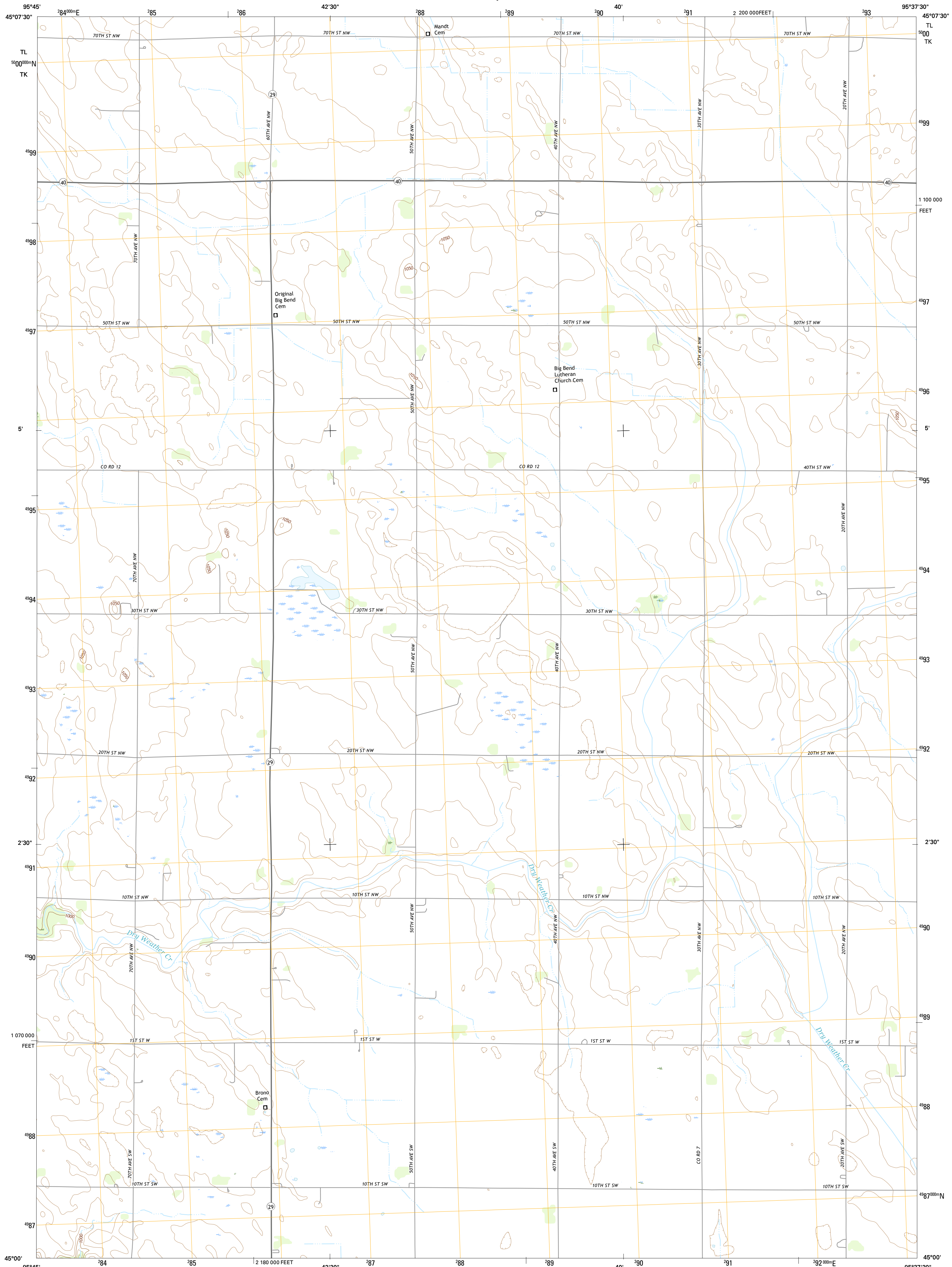

U.S. DEPARTMENT OF THE INTERIOR  
U.S. GEOLOGICAL SURVEY



GRACELOCK SW QUADRANGLE  
MINNESOTA-CHIPPEWA CO.  
7.5-MINUTE SERIES



Produced by the United States Geological Survey  
North American Datum of 1983 (NAD83)  
World Geodetic System of 1984 (WGS84). Projection and  
1000-meter grid: Universal Transverse Mercator, Zone 15T  
10 000-foot ticks: Minnesota Coordinate System of 1983 (south zone)

This map is not a legal document. Boundaries may be generalized for this map scale. Private lands within government reservations may not be shown. Obtain permission before entering private lands.

Imagery.....NAIP, July 2013  
Roads.....U.S. Census Bureau, 2015 - 2016  
Names.....GNIS, 2016  
Hydrography.....National Hydrography Dataset, 2013  
Contours.....National Elevation Dataset, 2013  
Boundaries.....Multiple sources; see metadata file 1972 - 2016  
Public Land Survey System.....BLA, 2014  
Wetlands.....FWS National Wetlands Inventory 1977 - 2014

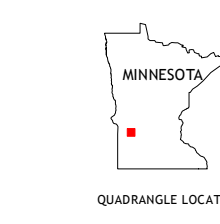
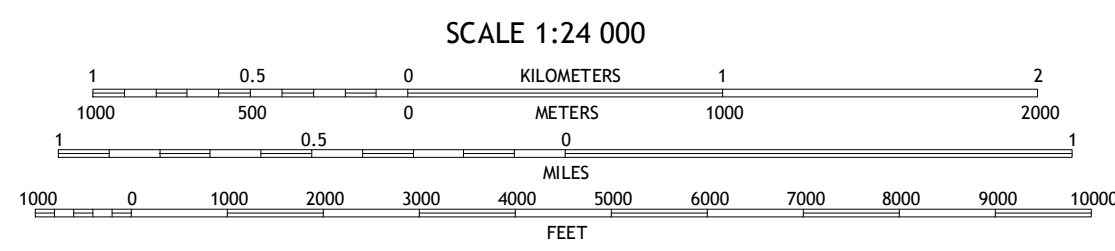
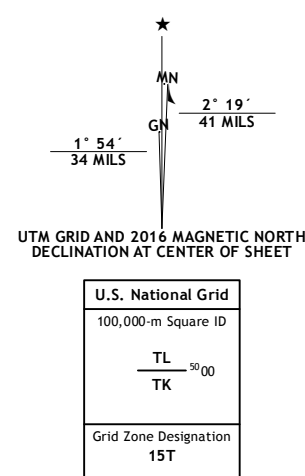

ADJOINING QUADRANGLES

1	2	3
4	5	6
7	8	

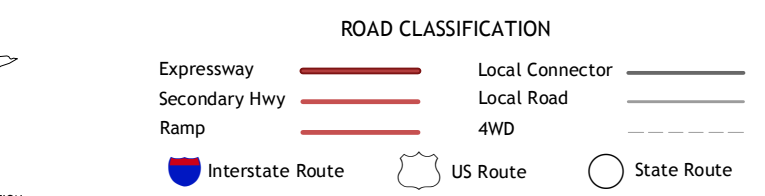

- 1 Big Bend City
- 2 Gracelock NW
- 3 Gracelock NE
- 4 Watson
- 5 Gracelock
- 6 Clarkfield NE
- 7 Montevideo
- 8 Asbury

GRACELOCK SW, MN  
2016

