

6681 IV NE (HULL SIDING)

UNITED STATES DEPARTMENT OF THE INTERIOR GEOLOGICAL SURVEY

STATE OF MINNESOTA DEPARTMENT OF ADMINISTRATION

HALLOCK QUADRANGLE MINNESOTA—KITSON CO. 7.5 MINUTE SERIES (TOPOGRAPHIC) SW/4 HALLOCK 15' QUADRANGLE

6681 IV NW (HALLOCK RD)

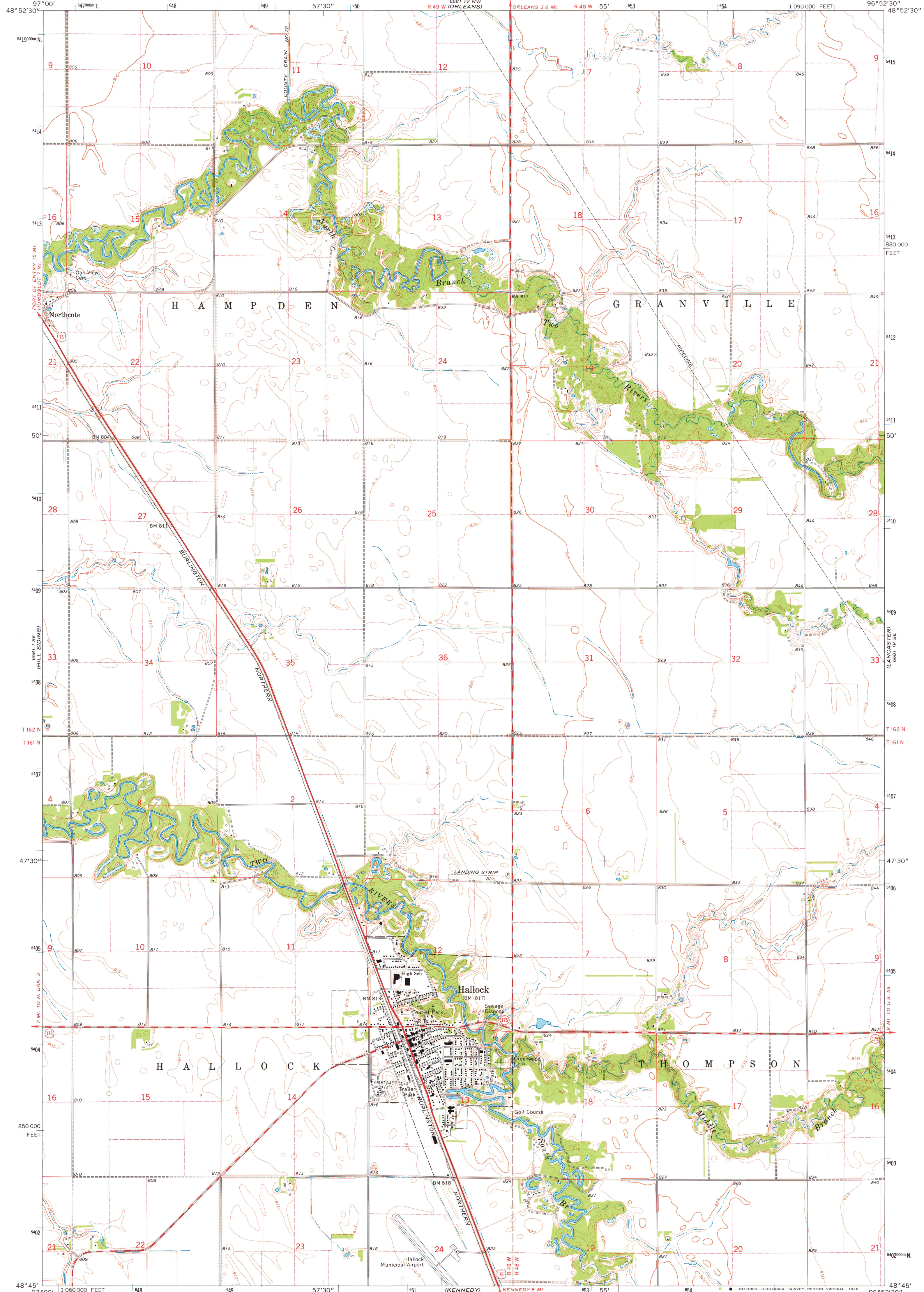

(KITSON) 6681 III E

Mapped, edited, and published by the Geological Survey Control by USGS and NOS/NOAA Topography by photogrammetric methods from aerial photographs taken 1973. Field checked 1974 Projection and 10,000-foot grid ticks: Minnesota coordinate system, north zone (Lambert conformal conic) 1000-metre Universal Transverse Mercator grid ticks, zone 14, shown in blue. 1927 North American datum Fine red dashed lines indicate selected fence and field lines where generally visible on aerial photographs This information is unchecked

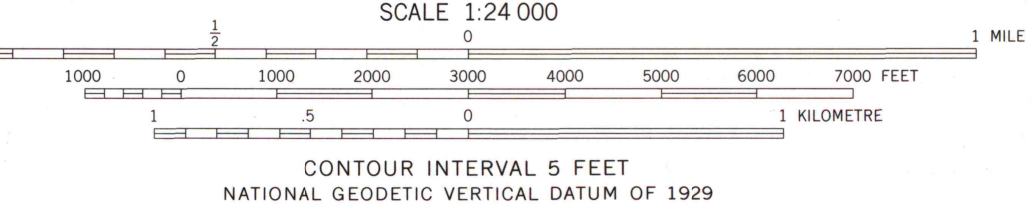
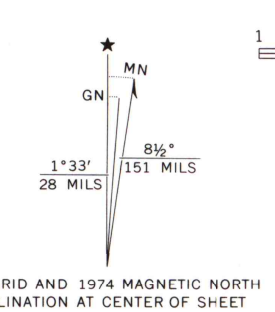

ROAD CLASSIFICATION

Primary highway, hard surface	Light-duty road, hard or improved surface
Secondary highway, hard surface	Unimproved road
Interstate Route	U. S. Route
	State Route

HALLOCK, MINN. SW/4 HALLOCK 15' QUADRANGLE N4845—W9652.5/7.5

THIS MAP COMPLIES WITH NATIONAL MAP ACCURACY STANDARDS FOR SALE BY U. S. GEOLOGICAL SURVEY, RESTON, VIRGINIA 22092 A FOLDER DESCRIBING TOPOGRAPHIC MAPS AND SYMBOLS IS AVAILABLE ON REQUEST

1974 AMS 6681 IV SW—SERIES V872

MAP AND AIR PHOTO LIBRARY JUN 3 1977 University of Wisconsin Madison