

(WHEATON)  
7:25:000

UNITED STATES  
DEPARTMENT OF THE INTERIOR  
GEOLOGICAL SURVEY

STATE OF MINNESOTA  
DEPARTMENT OF CONSERVATION  
CHESTER S. WILSON, COMMISSIONER

WHEATON QUADRANGLE  
MINNESOTA  
15 MINUTE SERIES (TOPOGRAPHIC)

(WENDELL)

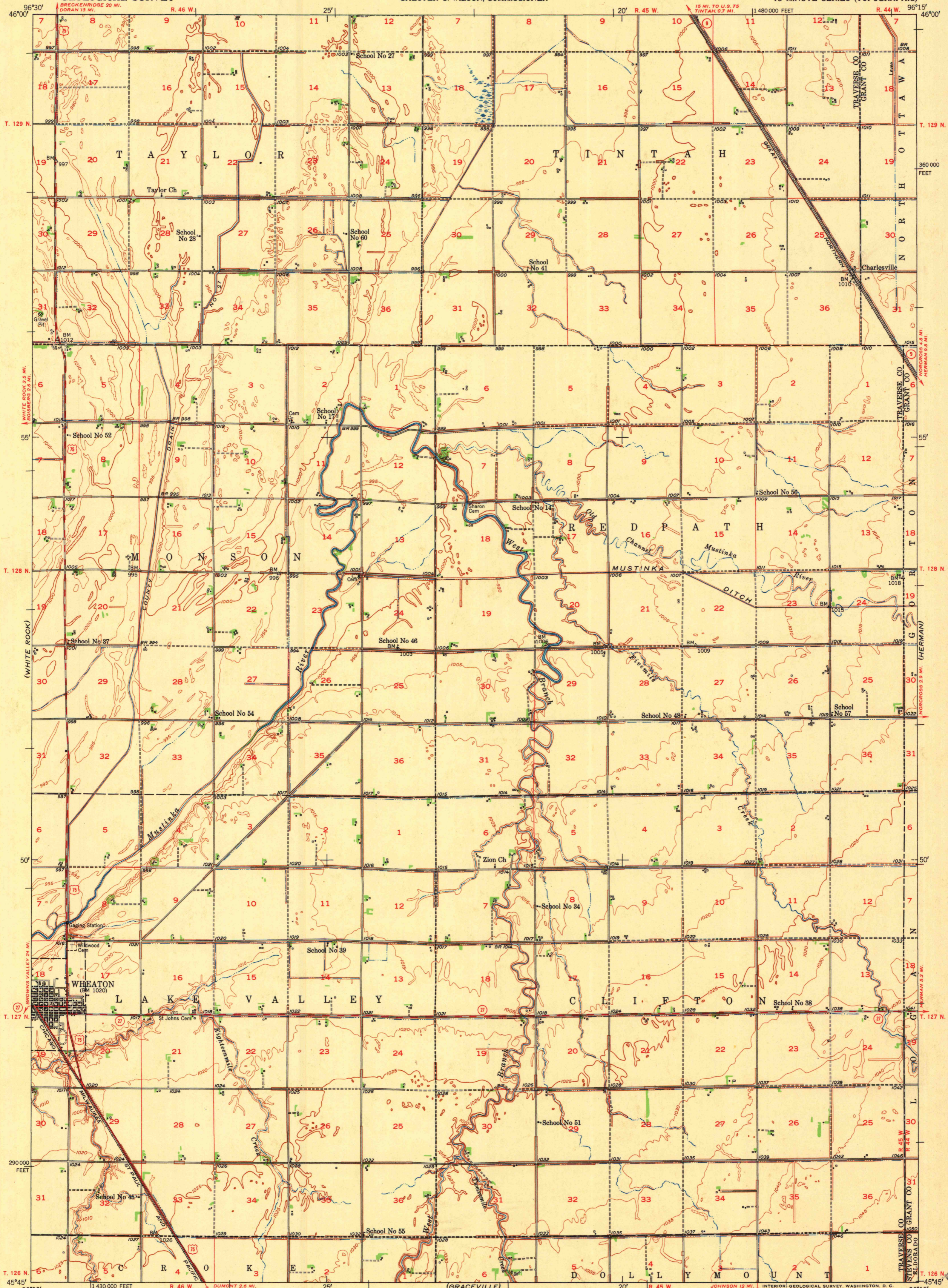

Mapped, edited, and published by the Geological Survey  
Control by USGS and USC&GS  
Culture and drainage in part compiled from  
aerial photographs taken 1949  
Topography by plane-table methods 1950  
Polyconic projection. 1927 North American datum  
10,000-foot grid based on Minnesota coordinate system,  
central zone

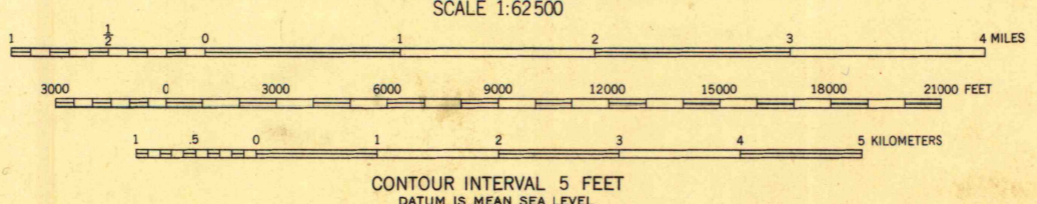
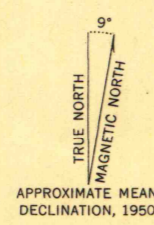

ROAD CLASSIFICATION

Heavy-duty	4 LANE LANE	Light-duty
Medium-duty	2 LANE LANE	Unimproved dirt

U.S. Route (square symbol)  
State Route (circle symbol)

WHEATON, MINN.  
N4545-W9615/15

THIS MAP COMPLIES WITH NATIONAL MAP ACCURACY STANDARDS  
FOR SALE BY U.S. GEOLOGICAL SURVEY, FEDERAL CENTER, DENVER, COLORADO OR WASHINGTON 25, D. C.  
A FOLDER DESCRIBING TOPOGRAPHIC MAPS AND SYMBOLS IS AVAILABLE ON REQUEST

EDITION OF 1951

(BEARDSLEY)

UNIVERSITY OF WISCONSIN  
Department of Geography  
(CHOKO)