

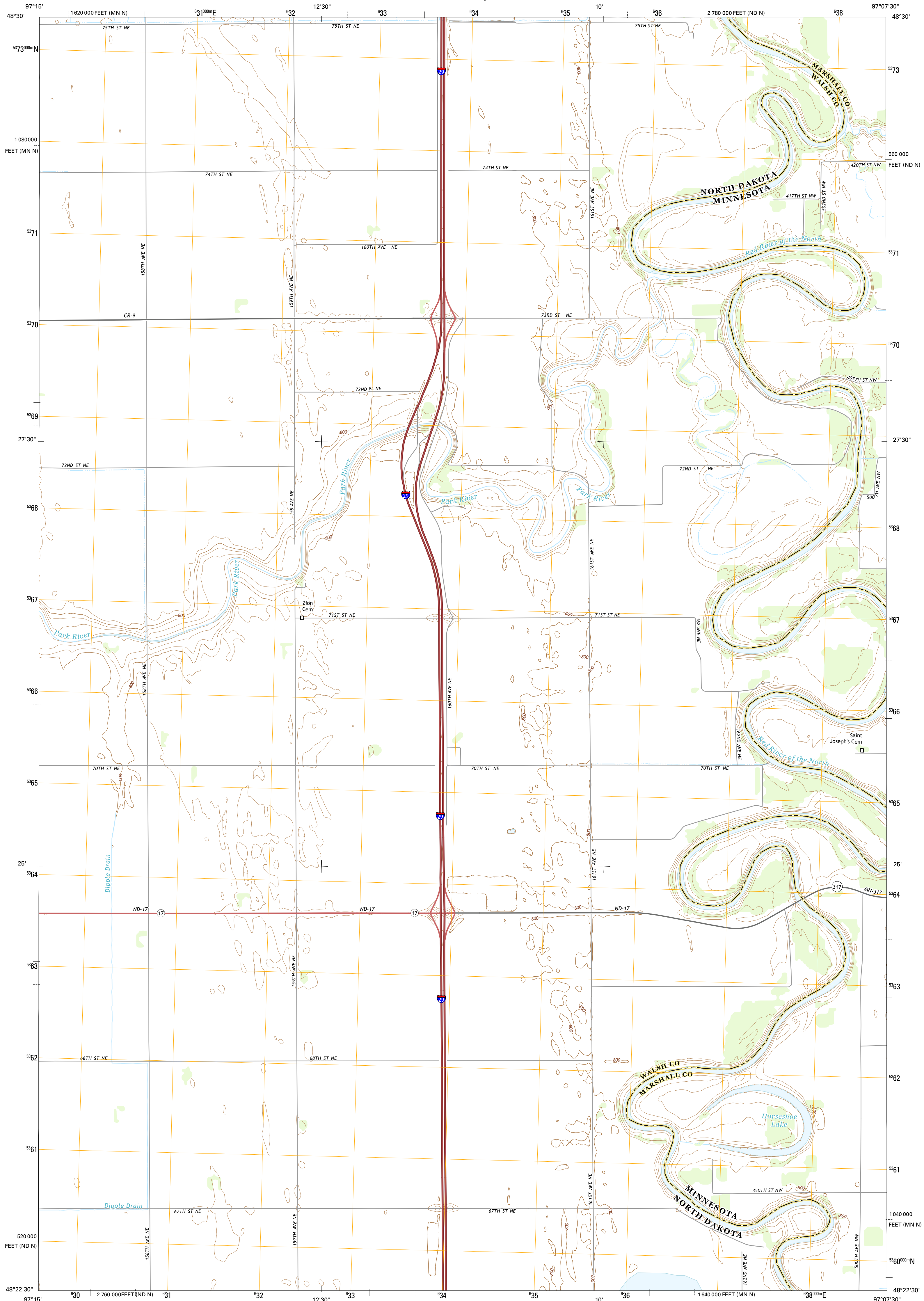

U.S. DEPARTMENT OF THE INTERIOR
U.S. GEOLOGICAL SURVEY



BIG WOODS NW QUADRANGLE
NORTH DAKOTA-MINNESOTA
7.5-MINUTE SERIES



Produced by the United States Geological Survey
North American Datum of 1983 (NAD83)
World Geodetic System of 1984 (WGS84). Projection and
1000-meter grid: Universal Transverse Mercator, Zone 14U
10 000-foot ticks: North Dakota Coordinate System of 1983
(north zone), Minnesota Coordinate System of 1983 (north zone)

This map is not a legal document. Boundaries may be
generalized for this map scale. Private lands within government
reservations may not be shown. Obtain permission before
entering private lands.

Imagery.....NAIP July 2012
Roads.....HERE 02013
Names.....GNIS 2013
Hydrography.....National Hydrography Dataset, 2012
Contours.....National Elevation Dataset, 2011
Boundaries.....Multiple sources; see metadata file 1972 - 2013

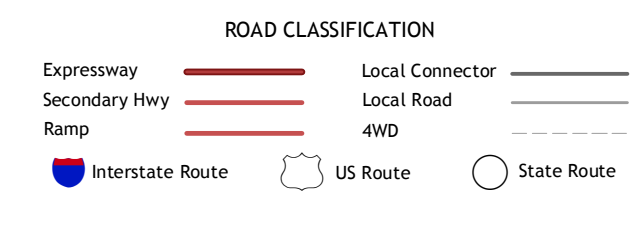
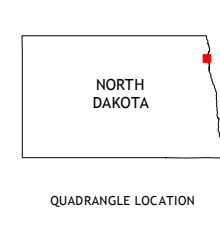
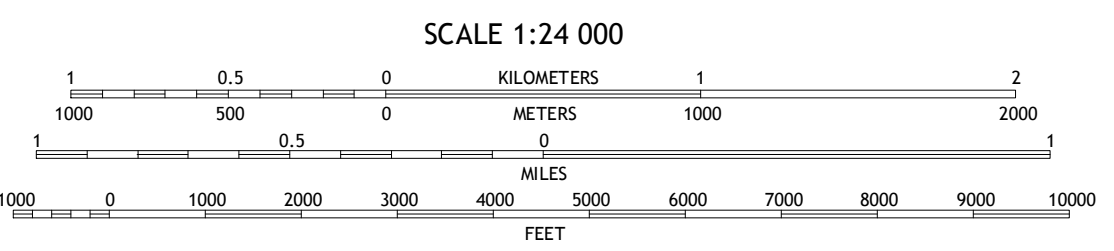
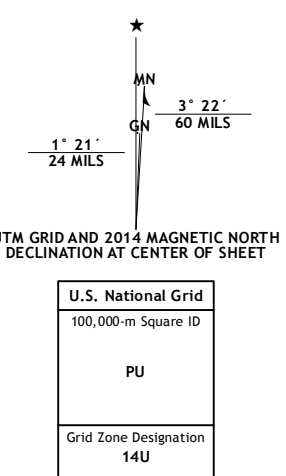

1	2	3
4	5	6
7	8	9

ADJOINING QUADRANGLES

1 North Salt Lake
2 Drayton
3 Drayton SE
4 Oakwood
5 Big Woods NE
6 Minto
7 Big Woods SW
8 Big Woods

BIG WOODS NW, ND-MN
2014

